

Project Title :SITE PLAN FOR L.U.C.C.

PROP. SITE PLAN SHOWING THE LAND OF (1) SRI. AMAN AGARWAL, PARTNER OF N.B. DEVELOPERS, (2) SRI. MAHESH KUMAR AGARWAL, (3) SMT. BADAMI DEVI AGARWAL AND (4) RAHUL AGARWAL AT I.T.I. ROAD, JYOTINAGAR, SILIGURI, P.S. BHAKTINAGAR, DIST. JALPAIGURI. WARD NO. 41 (S.M.C.)

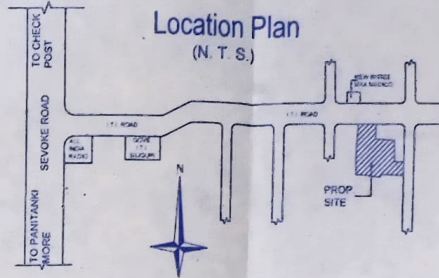

LATITUDE : 26° 44'10.56"N
LONGITUDE: 88° 26'39.60" E

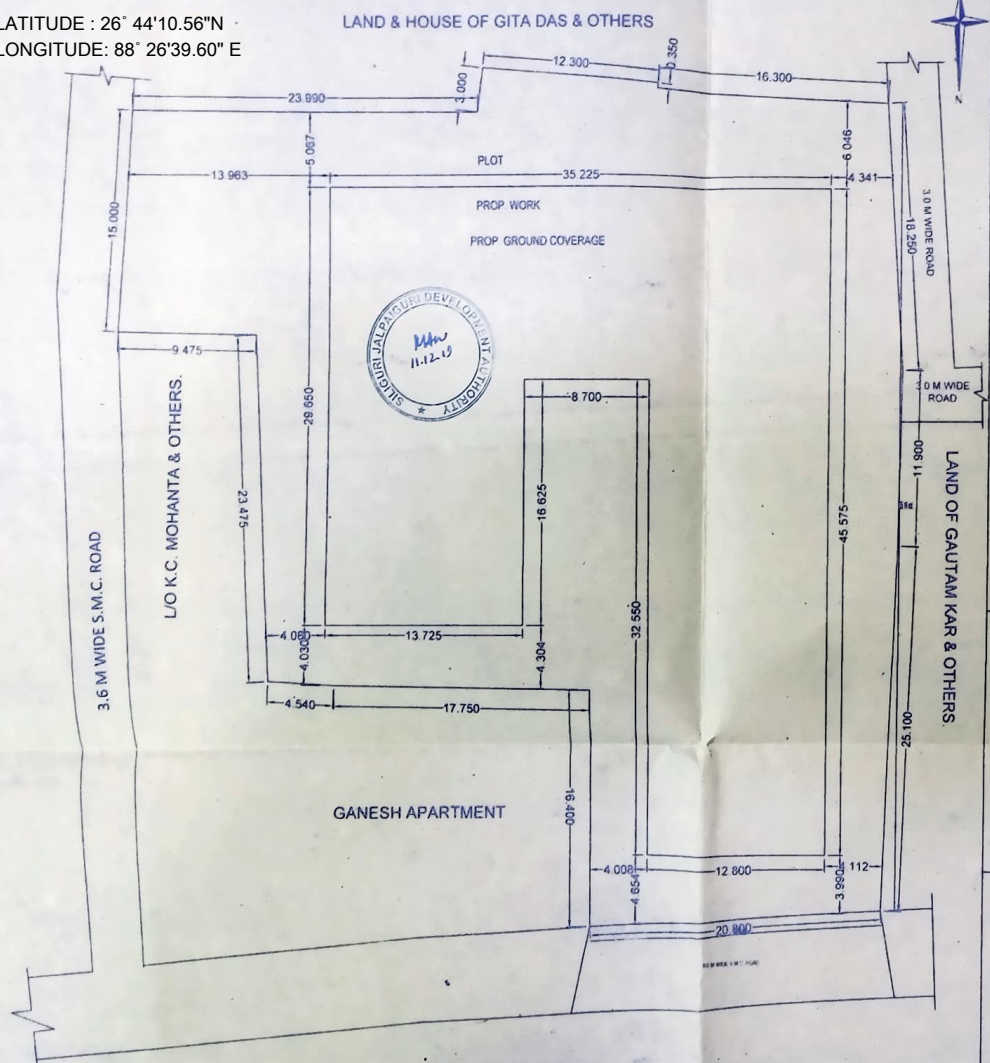
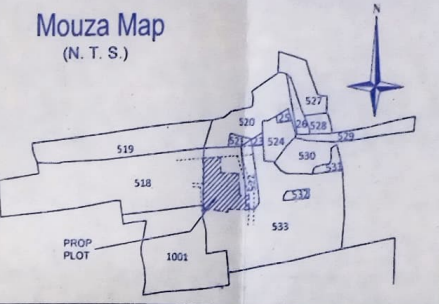

SITE PLAN

SCALE - 1:1 (FOR DRAWING)
SCALE - 1:100 (FOR PRINT)

SCHEDULE OF LAND

MOUZA - DABGRAM
PARGANA - BAIKUNTHAPUR
PLOT NO. - R.S. 533, L.R. 83
Khatian No. - R.S. 180,
J.L. NO. - 2
SHEET NO. - R.S. 8, L.R. 42
WARD NO. - 41 (S.M.C.)
POLICE ST. - BHAKTINAGAR
DISTRICT - JALPAIGURI.

LAND AREA

AS PER DEED - 2261.71 SQ. M.
AS PER KHATIAN - 2304.28 SQ. M.
AS PER SITE - 2261.65 SQ. M.

N. B. DEVELOPERS
Anand
Partner
Mahesh Kumar
Rahul Agarwal

SIGNATURE OF OWNERS

Somendra Bhadra
Somendra Bhadra
B.E. (Civil) M.I.E.
Licensed Building Surveyor
S.J.D.A, License No - LBS/A/5
e-mail - sbhadra65@gmail.com

SIGNATURE OF L. B. S.